

INSTRUCTIONS

FOLDING FIELD SHARPENER

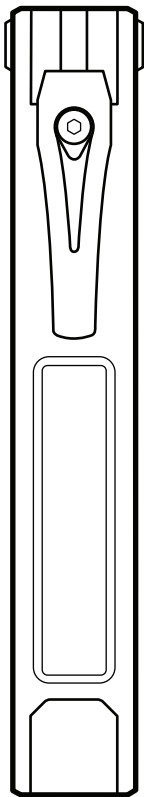

HOW TO SHARPEN

Use the Ceramic side of the Sharpener as a handle while sharpening on the Diamond Abrasive.

Place the side of the knife flat on the Angle Guide closest to the Pivot so the cutting edge is on the abrasive and **PUSH** the knife edge away and along the abrasive surface from heel to tip. Stop with the Tip of the knife on the abrasive.

Repeat this step using the opposing Angle Guide and **PULL** the knife edge toward and along the abrasive surface.

Alternate for 5-10 strokes per side.

⚠ WARNING: Do not use excessive pressure when drawing the blade towards yourself. Use light pressure or you risk severe injury or death.

Use the Diamond side of the sharpener as a handle and repeat the process on the Fine Ceramic plate to hone your edge.

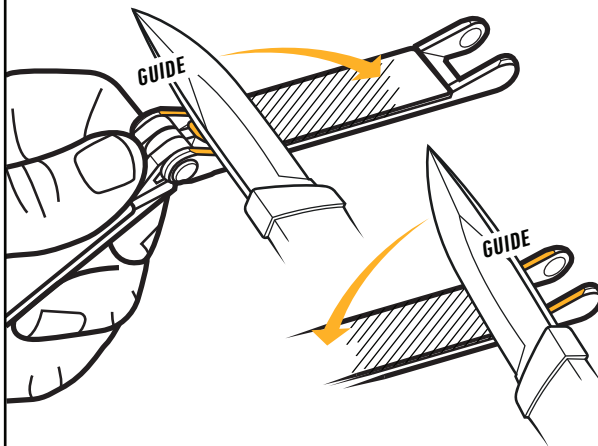

TIPS

- Hold the sharpener by the opposite handle that you are sharpening on to reduce the risk of injury. Do not rest the tool on yourself when in use.
- After a blade has been sharpened once, it can be re-sharpened (touch ups) using only the fine ceramic plate. After a number of touch ups it may take longer to re-sharpen. If this occurs, a few strokes on the diamond will re-shape the edge.
- Use the fine ceramic plate for blade applications requiring a very fine edge for delicate cutting or shaving.

MAINTENANCE

- Ceramic plate can be cleaned with warm water and dish soap.

GETTING TO KNOW YOUR SHARPENER

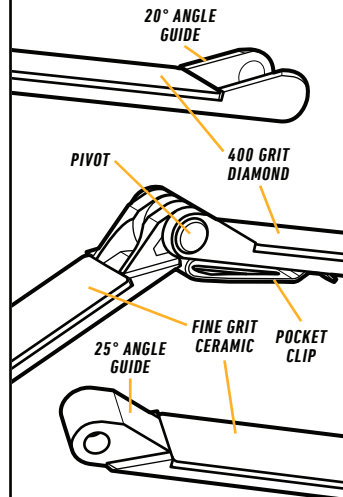

SAFETY

⚠ WARNING: Sharpening can be a dangerous task. Be aware of and in full control of your knife at all times or severe injury or death may occur.

Work Sharp® is a registered trademark of Darex, LLC
For Patent Info Visit: worksharptools.com/patents
Designed, calibrated and quality checked in
Ashland, OR using foreign components.



*Excludes Abrasives

WORKSHARPTOOLS.COM | 1.800.597.6170



**LEAVE A REVIEW WHERE YOU
PURCHASED YOUR PRODUCT**

WE VALUE YOUR HONEST FEEDBACK

WATCH
DEMO

